

# 95 Massassauga Rd, Belleville, ON

Main Building: Total Exterior Area 3139 sq ft

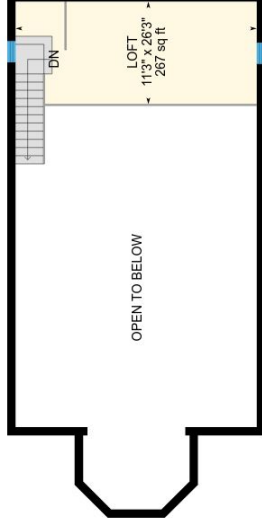

**Main Floor**  
Exterior Area 2594 sq ft



**Front loft**  
Exterior Area 397 sq ft

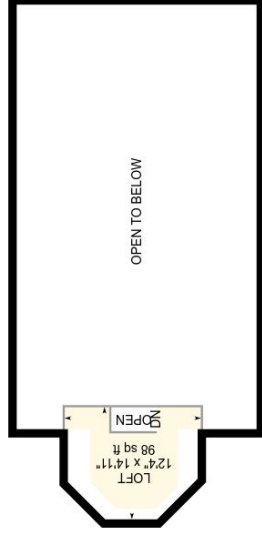

**Rear loft**  
Exterior Area 148 sq ft



PREPARED: Jul, 2018

# 95 Massassauga Rd, Belleville, ON

**Main Floor** Total Exterior Area 2594 sq ft  
Total Interior Area 2327 sq ft

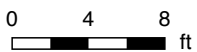

PREPARED: Jul, 2018

Colored regions are included in total floor area. All room dimensions and floor areas must be considered approximate and are subject to independent verification. For method of measurement please see <https://youriguide.com/measure/>.

# 95 Massassauga Rd, Belleville, ON

**Front loft** Total Exterior Area 397 sq ft  
Total Interior Area 314 sq ft

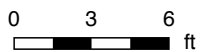
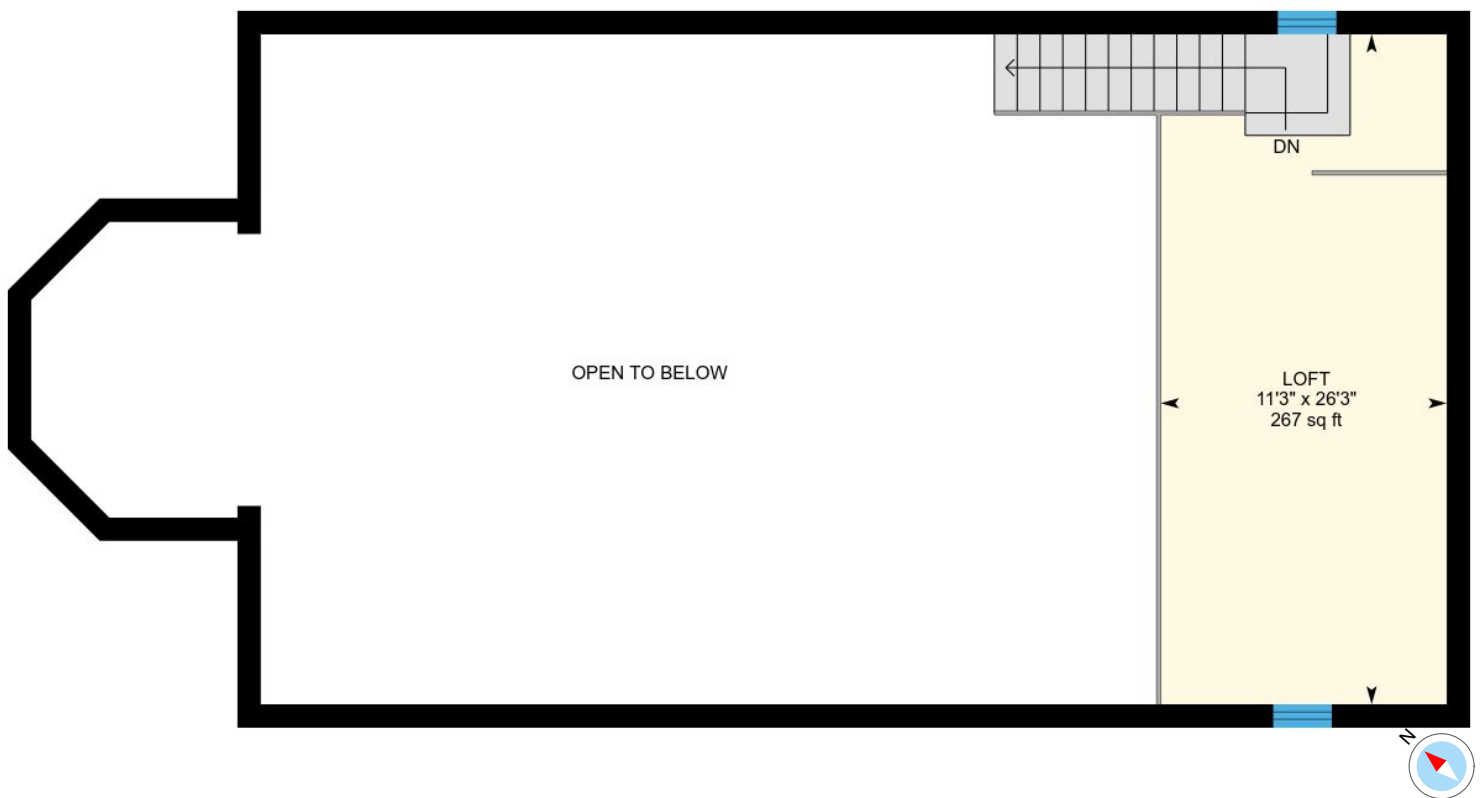

PREPARED: Jul, 2018

# 95 Massassauga Rd, Belleville, ON

**Rear loft** Total Exterior Area 148 sq ft  
Total Interior Area 98 sq ft

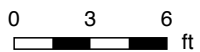

PREPARED: Jul, 2018

# 95 Massassauga Rd, Belleville, ON

---

## Property Details

### Room Measurements

Only major rooms are listed. Room dimensions are largest width and length, parts of room may be smaller. Room area is interior area and excludes footprint of walls.

### Main Building

#### MAIN FLOOR

Kitchen: 10'7" x 12'3" | 125 sq ft

Breakfast: 7'7" x 7'3" | 51 sq ft

Family: 14'1" x 18'10" | 241 sq ft

Living: 25'5" x 26'3" | 624 sq ft

Dining: 13'2" x 26'3" | 307 sq ft

Kitchen: 8'0" x 13'6" | 94 sq ft

4pc Bath: 7'1" x 7'10" | 56 sq ft

Laundry: 7'1" x 8'3" | 59 sq ft

4pc Bath: 7'8" x 8'4" | 52 sq ft

Bedroom: 10'9" x 10'7" | 90 sq ft

Utility: 10'7" x 6'2" | 65 sq ft

Bedroom: 11'5" x 11'3" | 128 sq ft

#### FRONT LOFT

Loft: 11'3" x 26'3" | 267 sq ft

#### REAR LOFT

Loft: 12'4" x 14'11" | 98 sq ft

### Floor Area Information

For explanation of floor area calculations and method of measurement please see <http://youriguide.com/measure/>

### Main Building

Building Perimeter Wall Thickness: 11 in

#### MAIN FLOOR

Interior Area: 2327 sq ft

Perimeter Wall Length: 291 ft

Exterior Area: 2594 sq ft

#### FRONT LOFT

Interior Area: 314 sq ft

Perimeter Wall Length: 91 ft

Exterior Area: 397 sq ft

#### REAR LOFT

Interior Area: 98 sq ft

Perimeter Wall Length: 55 ft

Exterior Area: 148 sq ft

### Total Floor Area

Main Building Interior: 2739 sq ft

**Main Building Exterior: 3139 sq ft**